

Preparation of compressed air → Maintenance units and components

**Series AS2**  
Accessories

**Pressure gauges, Series PG1 - SAS**

► Front port ► Background color: Black ► Scale color: White / Grey ► Viewing window: Polystyrene ► ATEX certified



00123444

ATEX	II 2G2D T4 X
Version	Bourdon tube pressure gauge
Standardization	EN 837-1
Main scale unit (outside)	bar
Secondary scale unit (inside)	psi
Ambient temperature min./max.	-40°C / +60°C
Medium	Compressed air
Pointer color	White
Main scale color (outside)	White
Secondary scale color (inside)	Grey
Class	2,5

Materials:	
Housing	Acrylonitrile butadiene styrene
Thread	Brass
Viewing window	Polystyrene
Seal	Polytetrafluorethylene

	Compressed air connection	Nominal diameter	Application		Display range	Operating pressure	Scale value	Weight	Part No.
			[mm]	[bar]	[bar]	[bar]	[bar]		
	G 1/4	50		0 - 1.2	0 - 1.6	0 / 1.6	0.05	0.09	<b>R412004413</b>
				0 - 2	0 - 2.5	0 / 2.5	0.1		<b>R412004414</b>
				0 - 3.2	0 - 4	0 / 4	0.1		<b>R412004415</b>
				0 - 4	0 - 6	0 / 6	0.2		<b>R412004416</b>
				0 - 8	0 - 10	0 / 10	0.2		<b>R412004417</b>
				0 - 12	0 - 16	0 / 16	0.5		<b>R412004418</b>

**Dimensions**

**InduParts Pneumatics B.V.B.A.**  
Sint-Jorisstraat 40  
B-8800 ROESELARE  
BELGIUM  
Tel. +31 (0)51 22 58 88  
Fax. +31 (0)51 22 58 98  
info@induparts.com  
www.induparts.com

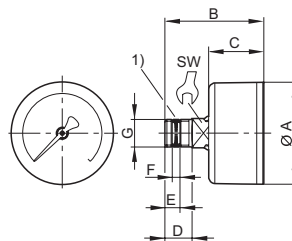

00119457

Compressed air connection G	Nominal diameter	Ø A	B	C	D	E	F 1)	SW				
G 1/4	50	49	47.5	26.5	13	7.2	3.7	14				

1) Gasket thread