



Alfafit



Components for Pneumatic Automation

Geluidsdempers - Silencieux Silencers - Schalldämpfer



werkdruk / pression de travail / working pressure / Betriebsdruck:
max. 12 bar

temperatuur / température / temperature / Temperatur: -10° ... +80°C

schroefdraad: BSP cilindrisch en M5

filetage: BSP cylindrique et M5

thread: BSPP and M5 Gewinde: BSP zylindrisch (G-Gewinde) und M5

materiaal: gesinterd brons, messing, kunststof en roest vast staal

matériaux: bronze fritté, laiton, plastic et acier inoxydable

materials: sintered bronze, brass, plastic and stainless steel

Werkstoffe: Sinterbronze, Messing, Kunststoff und Edelstahl

#: verpakking / emballage / packing / Verpackung

2124

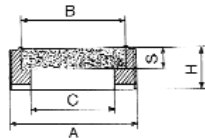

A	Alfafit	B	C	S	H	#
1/8	2124 10 00	7	5	2	4	10
1/4	2124 13 00	9	6	3	4	10
3/8	2124 17 00	11	8	4	5	10
1/2	2124 21 00	16	12	4	8	10
3/4	2124 27 00	22	17	4	10	10
1	2124 34 00	28	23	4	10	10

2104

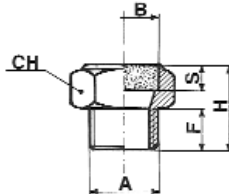

A	Alfafit	B	CH	F	S	H	#
1/8	2104 10 00	11	13	6	4	13	10
1/4	2104 13 00	14	16	8	4	16	10
3/8	2104 17 00	17	19	9	4	18	10
1/2	2104 21 00	22	24	11	4	20	10
3/4	2104 27 00	28	30	13	4	24	10
1	2104 34 00	34	36	15	4	27	10
1 1/4	2104 42 00						1
2	2104 60 00						1
M5	2104 05 00	6,5	8	3,5	3	8	10

2115

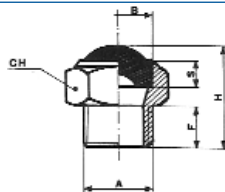

Roest vast staal - Acier inoxydable - Stainless steel - Edelstahl

A	Alfafit	B	CH	S	F	H	#
1/8	2115 10 00	11	13	4	6	16	10
1/4	2115 13 00	14	16	4	8	19	5
3/8	2115 17 00	17	19	4	9	21	5
1/2	2115 21 00	22	24	4	10	23	1
3/4	2115 27 00	28	30	4	10	27	1
1	2115 34 00	34	36	4	15	29	1
M5	2115 05 00						10

2101

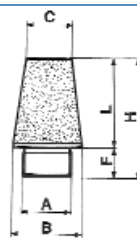

A	Alfafit	B	C	F	L	H	#
1/8	2101 10 00	12	8	6	15	21	10
1/4	2101 13 00	15	11	6	19	25	10
3/8	2101 17 00	19	15	8	28	36	10
1/2	2101 21 00	23	18	10	33	43	10
3/4	2101 27 00	30	23	13	40	53	10
1	2101 34 00	38	28	15	48	63	5
M5	2101 05 00	6	5	4,5	8,5	13	10

2100

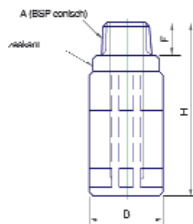

A	Alfafit	F	B	H	#
1/8	2100 10 00	8	10,3	35,5	10
1/4	2100 13 00	9	21,5	62,5	10
3/8	2100 17 00	13,7	24,6	83,2	10
1/2	2100 21 00	15,5	39,5	85,1	10

2107

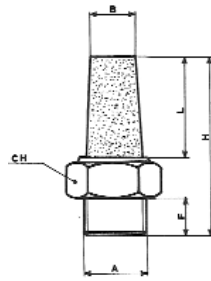

A	Alfafit	B	CH	F	L	H	#
1/8	2107 10 00	7	13	6	16	29	10
1/4	2107 13 00	9	16	8	16,5	32	10
3/8	2107 17 00	13	19	9	25,5	43	10
1/2	2107 21 00	16	24	11	33	53	10
3/4	2107 27 00	20	30	13	30	53	5
1	2107 34 00	25	36	15	39	66	5
1 1/4	2107 34 00	25	36	15	39	66	1
1 1/2	2107 34 00	25	36	15	39	66	1
2	2107 34 00	25	36	15	39	66	1
M5	2107 05 00	5	8	4	14	22	10

2130

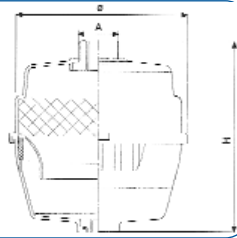

A	Alfafit	ØB	H	#
1/8	2130 10 00	65	68	1
1/4	2130 13 00	65	68	1
3/8	2130 17 00	95	95	1
1/2	2130 21 00	95	95	1
3/4	2130 27 00	131	134	1
1	2130 34 00	131	134	1

2141

Roest vast staal
Acier inoxydable
Stainless steel
Edelstahl

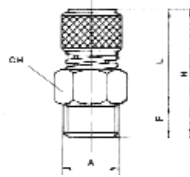

A	Alfafit	CH	F	L	L	H	H	#
				min	max	min	max	
1/8	2141 10 00	13	6	20	22	26	28	5
1/4	2141 13 00	15	8	22	24	30	32	5

2143

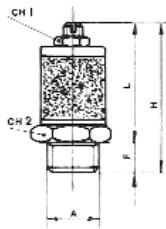

A	Alfafit	F	CH1	CH2	L	L	H	H	#
				min	max	min	max		
1/8	2143 10 00	8	10	16	30	36	38	44	10
1/4	2143 13 00	9	10	16	30	36	39	45	10
3/8	2143 17 00	10	10	22	37	50	47	60	5
1/2	2143 21 00	11	10	22	37	50	48	61	5
3/4	2143 27 00	11	13	30	56	80	68	92	5
1	2143 34 00	11	13	36	56	80	68	92	1
M5	2143 05 00	3,5	6	8	13	18	16	21	10

2146

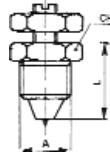

A	Alfafit	L	CH	#
1/8	2146 10 00	14	10	10
1/4	2146 13 00	16	13	10

InduParts Pneumatics B.V.B.A.
Sint-Jorisstraat 40
B-8800 ROESELARE
BELGIË
BE 0471.741.880

tel. +32 (0)51 22 58 88
fax. +32 (0)51 22 58 98
info@induparts.com
www.induparts.com