



# Alfafit



## Components for Pneumatic Automation



werkdruk / pression de travail / working pressure / Betriebsdruck:  
max. 12 bar

temperatuur / température / temperature / Temperatur: -10° ... +80°C

schroefdraad: BSP cilindrisch, BSP conisch en M5

filetage: BSP cylindrique, BSP conique et M5

thread: BSPP, BSPT and M5

Gewinde: BSP zylindr. (G-Gewinde), BSP conisch (R-Gewinde) und M5

materiaal: messing, kunststof en aluminium

matériaux: laiton, plastic et aluminium

materials: brass, plastic and aluminium

Werkstoffe: Messing, Kunststoff und Aluminium

#: verpakking / emballage / packing / Verpackung

1001

nippel, BSP conisch  
mamelou double, BSP conique  
straight male adaptor, BSPT  
Doppelnippel, konischem Gewinde

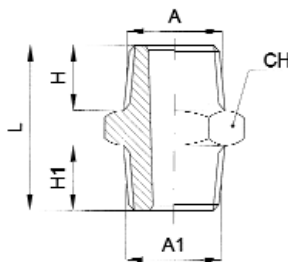

| Alfafit    | A1     | A      | H1  | H   | L    | CH | #  |
|------------|--------|--------|-----|-----|------|----|----|
| 1001 10 10 | 1/8"   | 1/8"   | 7,5 | 7,5 | 19,5 | 12 | 50 |
| 1001 10 13 | 1/8"   | 1/4"   | 7,5 | 10  | 22,5 | 14 | 50 |
| 1001 10 17 | 1/8"   | 3/8"   | 7,5 | 10  | 22,5 | 17 | 50 |
| 1001 13 13 | 1/4"   | 1/4"   | 10  | 10  | 25   | 14 | 50 |
| 1001 13 17 | 1/4"   | 3/8"   | 10  | 10  | 25   | 17 | 10 |
| 1001 13 21 | 1/4"   | 1/2"   | 10  | 12  | 28   | 22 | 10 |
| 1001 17 17 | 3/8"   | 3/8"   | 10  | 10  | 25   | 17 | 10 |
| 1001 17 21 | 3/8"   | 1/2"   | 10  | 12  | 28   | 22 | 10 |
| 1001 21 21 | 1/2"   | 1/2"   | 12  | 12  | 30   | 22 | 10 |
| 1001 21 27 | 1/2"   | 3/4"   | 12  | 14  | 32   | 27 | 10 |
| 1001 27 27 | 3/4"   | 3/4"   | 14  | 14  | 34   | 27 | 10 |
| 1001 27 34 | 3/4"   | 1"     | 14  | 16  | 37   | 34 | 5  |
| 1001 34 34 | 1"     | 1"     | 16  | 16  | 39   | 34 | 5  |
| 1001 34 42 | 1"     | 1" 1/4 | 15  | 20  | 44   | 48 | 2  |
| 1001 42 42 | 1" 1/4 | 1" 1/4 | 20  | 20  | 49   | 48 | 2  |
| 1001 42 48 | 1" 1/4 | 1" 1/2 | 20  | 23  | 53   | 54 | 2  |
| 1001 48 48 | 1" 1/2 | 1" 1/2 | 23  | 23  | 56   | 54 | 2  |
| 1001 48 60 | 1" 1/2 | 2"     | 23  | 24  | 57   | 66 | 2  |
| 1001 60 60 | 2"     | 2"     | 24  | 24  | 58   | 66 | 1  |

1101

nippel, BSP cilindrisch  
mamelou double, BSP cylindrique  
straight male adaptor, BSPP  
Doppelnippel, zylindrischem Gewinde

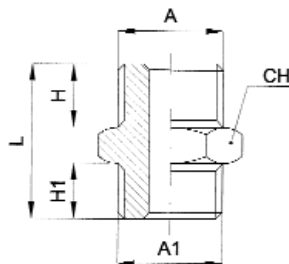

| Alfafit    | A1   | A    | H1 | H  | L    | CH | #  |
|------------|------|------|----|----|------|----|----|
| 1101 05 05 | M5   | M5   | 4  | 4  | 11   | 8  | 50 |
| 1101 05 10 | M5   | 1/8" | 4  | 6  | 14   | 14 | 50 |
| 1101 10 10 | 1/8" | 1/8" | 6  | 6  | 16,5 | 14 | 50 |
| 1101 10 13 | 1/8" | 1/4" | 6  | 8  | 19   | 17 | 50 |
| 1101 10 17 | 1/8" | 3/8" | 6  | 9  | 20   | 19 | 50 |
| 1101 13 13 | 1/4" | 1/4" | 8  | 8  | 21   | 17 | 50 |
| 1101 13 17 | 1/4" | 3/8" | 8  | 9  | 22   | 19 | 10 |
| 1101 13 21 | 1/4" | 1/2" | 8  | 10 | 23,5 | 24 | 10 |
| 1101 17 17 | 3/8" | 3/8" | 9  | 9  | 23   | 19 | 10 |
| 1101 17 21 | 3/8" | 1/2" | 9  | 10 | 24,5 | 24 | 10 |
| 1101 17 27 | 3/8" | 3/4" | 9  | 11 | 30   | 30 | 10 |
| 1101 21 21 | 1/2" | 1/2" | 10 | 10 | 25,5 | 24 | 10 |
| 1101 21 27 | 1/2" | 3/4" | 10 | 11 | 27   | 30 | 10 |
| 1101 27 27 | 3/4" | 3/4" | 11 | 11 | 28   | 30 | 10 |
| 1101 27 34 | 3/4" | 1"   | 11 | 12 | 30   | 36 | 5  |
| 1101 34 34 | 1"   | 1"   | 12 | 12 | 31   | 36 | 5  |

1028

nippel, BSP conisch  
mamelou double, BSP conique  
straight male adaptor, BSPT  
Doppelnippel, konischem Gewinde

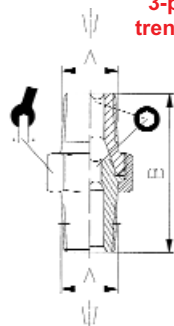

| Alfafit    | A           | B  | Ø   | a  | b  | #  |
|------------|-------------|----|-----|----|----|----|
| 1028 10 10 | 1/8"        | 27 | 5,3 | 15 | 5  | 10 |
| 1028 10 13 | 1/8" - 1/4" | 30 | 5,3 | 15 | 5  | 10 |
| 1028 13 13 | 1/4"        | 34 | 6,3 | 19 | 6  | 10 |
| 1028 13 17 | 1/4" - 3/8" | 35 | 6,3 | 19 | 6  | 5  |
| 1028 17 17 | 3/8"        | 36 | 8,5 | 22 | 8  | 5  |
| 1028 21 21 | 1/2"        | 44 | 13  | 27 | 12 | 5  |
| 1028 27 27 | 3/4"        | 52 | 15  | 36 | 14 | 2  |
| 1028 34 34 | 1"          | 65 | 20  | 46 | 19 | 1  |

# 1102

sok, BSP cilindrisch  
**manchon double femelle**, BSP cylindrique  
**double female sleeve**, BSPP  
**Muffe**, zylindrischem Gewinde

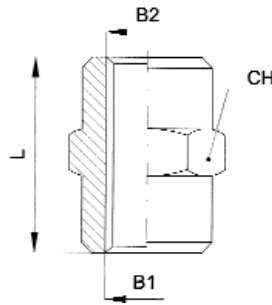

|            | B1   | B2   | L  | CH | #  |
|------------|------|------|----|----|----|
| 1102 05 05 | M5   | M5   | 11 | 8  | 10 |
| 1102 05 10 | M5   | 1/8" | 13 | 14 | 10 |
| 1102 10 10 | 1/8" | 1/8" | 15 | 14 | 10 |
| 1102 10 13 | 1/8" | 1/4" | 19 | 17 | 10 |
| 1102 10 17 | 1/8" | 3/8" | 20 | 22 | 10 |
| 1102 13 13 | 1/4" | 1/4" | 22 | 17 | 10 |
| 1102 13 17 | 1/4" | 3/8" | 23 | 22 | 10 |
| 1102 13 21 | 1/4" | 1/2" | 26 | 27 | 10 |
| 1102 17 17 | 3/8" | 3/8" | 24 | 27 | 10 |
| 1102 17 21 | 3/8" | 1/2" | 26 | 22 | 10 |
| 1102 17 27 | 3/8" | 3/4" | 26 | 32 | 10 |
| 1102 21 21 | 1/2" | 1/2" | 29 | 27 | 10 |
| 1102 21 27 | 1/2" | 3/4" | 30 | 32 | 10 |
| 1102 21 34 | 1/2" | 1"   | 26 | 38 | 5  |
| 1102 27 27 | 3/4" | 3/4" | 32 | 32 | 10 |
| 1102 27 34 | 3/4" | 1"   | 34 | 38 | 5  |
| 1102 34 34 | 1"   | 1"   | 34 | 38 | 5  |

# 1114

schotdoorvoer, BSP cilindrisch  
**traversée de cloison femelle**, BSP cylindrique  
**bulkhead fitting**, BSPP  
**Schottverschraubung**, zylindrischem Gewinde

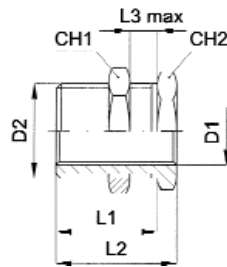

|            | D1   | D2      | L1   | L2   | CH1 | CH2 | L3max | #  |
|------------|------|---------|------|------|-----|-----|-------|----|
| 1114 05 05 | M5   | M10x1   | 10,5 | 14   | 14  | 14  |       | 10 |
| 1114 10 10 | 1/8" | M16x1,5 | 14   | 18   | 22  | 19  |       | 10 |
| 1114 13 13 | 1/4" | M20x1,5 | 21   | 25   | 27  | 24  |       | 10 |
| 1114 17 17 | 3/8" | M26x1,5 | 21   | 26   | 32  | 30  |       | 10 |
| 1114 21 21 | 1/2" | M28x1,5 | 27   | 33,0 | 36  | 32  |       | 5  |

# 1006

vermindering, buiten BSP conisch, binnen BSP cilindrisch  
**adapteur mâle** BSP conique - **femelle** BSP cylindrique  
**reducer male** BSPT to female BSPP  
**Reduzierung**, konischem Außengewinde, zylindrischem Innengewinde

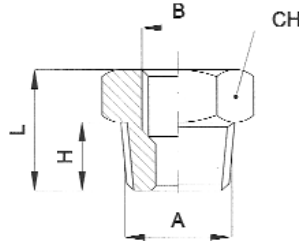

|            | A      | B      | H  | L    | CH | #  |
|------------|--------|--------|----|------|----|----|
| 1006 13 10 | 1/4"   | 1/8"   | 10 | 15   | 14 | 50 |
| 1006 17 10 | 3/8"   | 1/8"   | 10 | 15   | 17 | 50 |
| 1006 17 13 | 3/8"   | 1/4"   | 10 | 15   | 17 | 50 |
| 1006 21 10 | 1/2"   | 1/8"   | 13 | 19   | 22 | 10 |
| 1006 21 13 | 1/2"   | 1/4"   | 13 | 19   | 22 | 10 |
| 1006 21 17 | 1/2"   | 3/8"   | 13 | 19   | 22 | 10 |
| 1006 27 13 | 3/4"   | 1/4"   | 14 | 20,5 | 27 | 10 |
| 1006 27 17 | 3/4"   | 3/8"   | 14 | 20,5 | 27 | 10 |
| 1006 27 21 | 3/4"   | 1/2"   | 14 | 20,5 | 27 | 10 |
| 1006 34 17 | 1"     | 3/8"   | 16 | 22   | 34 | 5  |
| 1006 34 21 | 1"     | 1/2"   | 16 | 22   | 34 | 5  |
| 1006 34 27 | 1"     | 3/4"   | 16 | 22   | 34 | 5  |
| 1006 42 34 | 1" 1/4 | 1"     | 21 | 29   | 44 | 2  |
| 1006 48 34 | 1" 1/2 | 1"     | 24 | 33   | 48 | 2  |
| 1006 48 42 | 1" 1/2 | 1" 1/4 | 24 | 33   | 48 | 2  |
| 1006 60 42 | 2"     | 1" 1/4 | 25 | 36   | 61 | 1  |
| 1006 60 48 | 2"     | 1" 1/2 | 25 | 36   | 61 | 1  |

# 1106

vermindering, BSP cilindrisch  
**adapteur mâle - femelle**, BSP cylindrique  
**reducer male to female**, BSPP  
**Reduzierung**, zylindrischem Gewinde

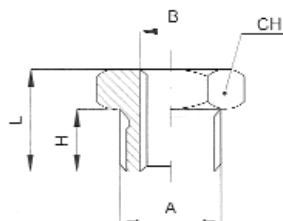

|            | A    | B    | H  | L  | CH | #  |
|------------|------|------|----|----|----|----|
| 1106 10 05 | 1/8" | M5   | 6  | 10 | 14 | 50 |
| 1106 13 10 | 1/4" | 1/8" | 8  | 13 | 17 | 50 |
| 1106 17 10 | 3/8" | 1/8" | 9  | 14 | 19 | 50 |
| 1106 17 13 | 3/8" | 1/4" | 9  | 14 | 19 | 50 |
| 1106 21 10 | 1/2" | 1/8" | 9  | 15 | 24 | 10 |
| 1106 21 13 | 1/2" | 1/4" | 9  | 15 | 24 | 10 |
| 1106 21 17 | 1/2" | 3/8" | 9  | 15 | 24 | 10 |
| 1106 27 13 | 3/4" | 1/4" | 11 | 17 | 30 | 10 |
| 1106 27 17 | 3/4" | 3/8" | 11 | 17 | 30 | 10 |
| 1106 27 21 | 3/4" | 1/2" | 11 | 17 | 30 | 10 |
| 1106 34 17 | 1"   | 3/8" | 12 | 19 | 36 | 5  |
| 1106 34 21 | 1"   | 1/2" | 12 | 19 | 36 | 5  |
| 1106 34 27 | 1"   | 3/4" | 12 | 19 | 36 | 5  |



# 1007

**neusstuk**, buiten BSP conisch, binnen BSP cilindrisch  
**grossiseur mâle** BSP conique - **femelle** BSP cylindrique  
**increaser male** BSPT to female BSPP  
**Gewindestutzen**, konischem Außengewinde, zylindrischem Innengewinde

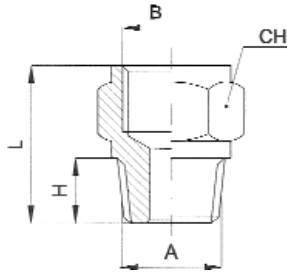

| Alfafit    | A    | B    | H   | L    | CH | #  |
|------------|------|------|-----|------|----|----|
| 1007 10 10 | 1/8" | 1/8" | 7,5 | 17,5 | 14 | 50 |
| 1007 10 13 | 1/8" | 1/4" | 7,5 | 21   | 17 | 50 |
| 1007 10 17 | 1/8" | 3/8" | 7,5 | 22   | 22 | 10 |
| 1007 13 13 | 1/4" | 1/4" | 10  | 24   | 17 | 10 |
| 1007 13 17 | 1/4" | 3/8" | 10  | 26   | 22 | 10 |
| 1007 13 21 | 1/4" | 1/2" | 10  | 28   | 27 | 10 |
| 1007 17 17 | 3/8" | 3/8" | 10  | 26   | 22 | 10 |
| 1007 17 21 | 3/8" | 1/2" | 10  | 28   | 27 | 10 |
| 1007 21 21 | 1/2" | 1/2" | 12  | 30   | 27 | 10 |
| 1007 17 27 | 3/8" | 3/4" | 10  | 27   | 32 | 10 |
| 1007 21 27 | 1/2" | 3/4" | 13  | 30   | 32 | 10 |
| 1007 27 27 | 3/4" | 3/4" | 14  | 31   | 32 | 10 |
| 1007 21 34 | 1/2" | 1"   | 13  | 32   | 38 | 5  |
| 1007 27 34 | 3/4" | 1"   | 14  | 33   | 38 | 5  |
| 1007 34 34 | 1"   | 1"   | 16  | 35   | 38 | 5  |

# 1108

BSP cilindrisch / BSP cylindrique / BSPP / zylindrischem Gewinde

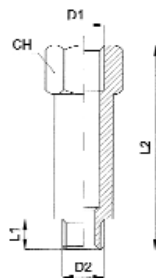

| Alfafit    | D1   | D2   | L1 | L2 | CH | #  |
|------------|------|------|----|----|----|----|
| 1108 10 22 | 1/8" | 1/8" | 6  | 22 | 14 | 10 |
| 1108 10 44 | 1/8" | 1/8" | 6  | 44 | 12 | 10 |
| 1108 13 28 | 1/4" | 1/4" | 8  | 28 | 16 | 10 |
| 1108 13 45 | 1/4" | 1/4" | 8  | 45 | 16 | 10 |
| 1108 17 41 | 3/8" | 3/8" | 9  | 41 | 22 | 10 |
| 1108 21 36 | 1/2" | 1/2" | 9  | 36 | 27 | 5  |
| 1108 27 50 | 3/4" | 3/4" | 11 | 50 | 32 | 2  |
| 1108 34 50 | 1"   | 1"   | 11 | 50 | 38 | 2  |

# 1103

BSP cilindrisch / BSP cylindrique / BSPP / zylindrischem Gewinde

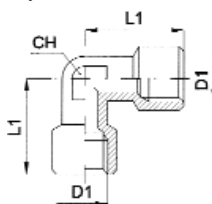

| Alfafit    | D1   | CH | L1 | #  |
|------------|------|----|----|----|
| 1103 05 05 | M5   | 8  | 9  | 10 |
| 1103 10 10 | 1/8" | 10 | 19 | 10 |
| 1103 13 13 | 1/4" | 12 | 25 | 10 |
| 1103 17 17 | 3/8" | 16 | 28 | 10 |
| 1103 21 21 | 1/2" | 20 | 34 | 5  |
| 1103 27 27 | 3/4" | 27 | 37 | 5  |
| 1103 34 34 | 1"   | 30 | 45 | 2  |

# 1015

buitendr. BSP con., binnendr. BSP cil. / fil. mâle: BSP con., fil. fem.: BSP cyl.  
 male thread: BSPT, female thread: BSPP / R-Außengew., G-Innengew.

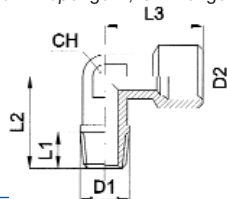

| Alfafit    | D1   | D2   | CH | L1 | L2 | L3 | #  |
|------------|------|------|----|----|----|----|----|
| 1015 05 05 | M5   | M5   | 8  | 4  | 14 | 9  | 10 |
| 1015 10 10 | 1/8" | 1/8" | 10 | 7  | 19 | 19 | 10 |
| 1015 13 13 | 1/4" | 1/4" | 12 | 10 | 24 | 25 | 10 |
| 1015 17 17 | 3/8" | 3/8" | 16 | 11 | 26 | 28 | 10 |
| 1015 21 21 | 1/2" | 1/2" | 20 | 13 | 31 | 34 | 5  |
| 1015 27 27 | 3/4" | 3/4" | 27 | 15 | 32 | 37 | 5  |
| 1015 34 34 | 1"   | 1"   | 30 | 17 | 39 | 45 | 2  |

# 1016

BSP conisch / BSP conique / BSPT / konischem Gewinde

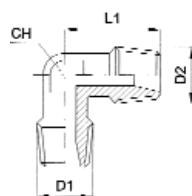

| Alfafit    | D1   | D2   | CH | L1 | #  |
|------------|------|------|----|----|----|
| 1016 05 05 | M5   | M5   | 8  | 14 | 10 |
| 1016 10 10 | 1/8" | 1/8" | 10 | 19 | 10 |
| 1016 13 13 | 1/4" | 1/4" | 12 | 24 | 10 |
| 1016 17 17 | 3/8" | 3/8" | 16 | 26 | 10 |
| 1016 21 21 | 1/2" | 1/2" | 20 | 31 | 10 |
| 1016 27 27 | 3/4" | 3/4" | 27 | 32 | 5  |
| 1016 34 34 | 1"   | 1"   | 30 | 39 | 2  |

**1105**

BSP cilindrisch / BSP cylindrique / BSPP / zylindrischem Gewinde

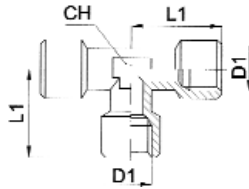

| Alfafit    | D1   | CH | L1 | #  |
|------------|------|----|----|----|
| 1105 05 05 | M5   | 8  | 9  | 10 |
| 1105 10 10 | 1/8" | 10 | 19 | 10 |
| 1105 13 13 | 1/4" | 12 | 25 | 10 |
| 1105 17 17 | 3/8" | 16 | 28 | 5  |
| 1105 21 21 | 1/2" | 20 | 34 | 5  |
| 1105 27 27 | 3/4" | 27 | 37 | 2  |
| 1105 34 34 | 1"   | 30 | 45 | 2  |

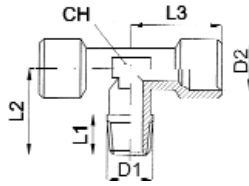
**1017**buitendr. BSP con., binnendr. BSP cil. / fil. mâle: BSP con., fil. fem.: BSP cyl.  
male thread: BSPT, female thread: BSPP / R-Außengew., G-Innengew.

| Alfafit    | D1   | D2   | L1 | CH | L2 | L3 | #  |
|------------|------|------|----|----|----|----|----|
| 1017 05 05 | M5   | M5   | 4  | 8  | 14 | 9  | 10 |
| 1017 10 10 | 1/8" | 1/8" | 7  | 10 | 19 | 19 | 10 |
| 1017 13 13 | 1/4" | 1/4" | 10 | 12 | 24 | 25 | 10 |
| 1017 17 17 | 3/8" | 3/8" | 11 | 16 | 26 | 28 | 10 |
| 1017 21 21 | 1/2" | 1/2" | 13 | 20 | 31 | 34 | 5  |
| 1017 27 27 | 3/4" | 3/4" | 15 | 27 | 32 | 37 | 2  |
| 1017 34 34 | 1"   | 1"   | 17 | 30 | 39 | 45 | 2  |

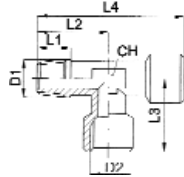
**1018**buitendr. BSP con., binnendr. BSP cil. / fil. mâle: BSP con., fil. fem.: BSP cyl.  
male thread: BSPT, female thread: BSPP / R-Außengew., G-Innengew.

| Alfafit    | D1   | D2   | L1 | CH | L2 | L3 | L4 | #  |
|------------|------|------|----|----|----|----|----|----|
| 1018 05 05 | M5   | M5   | 4  | 8  | 14 | 9  | 23 | 10 |
| 1018 10 10 | 1/8" | 1/8" | 7  | 10 | 19 | 19 | 38 | 10 |
| 1018 13 13 | 1/4" | 1/4" | 10 | 12 | 24 | 25 | 49 | 10 |
| 1018 17 17 | 3/8" | 3/8" | 11 | 16 | 26 | 28 | 54 | 10 |
| 1018 21 21 | 1/2" | 1/2" | 13 | 20 | 31 | 34 | 65 | 5  |
| 1018 27 27 | 3/4" | 3/4" | 15 | 27 | 32 | 37 | 69 | 2  |
| 1018 34 34 | 1"   | 1"   | 17 | 30 | 39 | 45 | 84 | 2  |

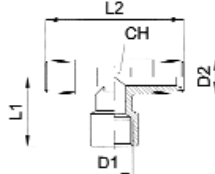
**1019**buitendr. BSP con., binnendr. BSP cil. / fil. mâle: BSP con., fil. fem.: BSP cyl.  
male thread: BSPT, female thread: BSPP / R-Außengew., G-Innengew.

| Alfafit    | D1   | D2   | CH | L1 | L2 | #  |
|------------|------|------|----|----|----|----|
| 1019 05 05 | M5   | M5   | 8  | 9  | 28 | 10 |
| 1019 10 10 | 1/8" | 1/8" | 10 | 19 | 39 | 10 |
| 1019 13 13 | 1/4" | 1/4" | 12 | 25 | 48 | 10 |
| 1019 17 17 | 3/8" | 3/8" | 16 | 28 | 52 | 10 |
| 1019 21 21 | 1/2" | 1/2" | 20 | 34 | 62 | 5  |
| 1019 27 27 | 3/4" | 3/4" | 27 | 37 | 64 | 2  |
| 1019 34 34 | 1"   | 1"   | 30 | 45 | 78 | 2  |

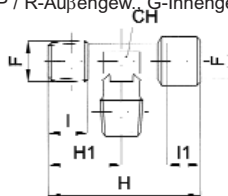
**1020**buitendr. BSP con., binnendr. BSP cil. / fil. mâle: BSP con., fil. fem.: BSP cyl.  
male thread: BSPT, female thread: BSPP / R-Außengew., G-Innengew.

| Alfafit    | F    | CH | I1 | H  | H1 | I  | #  |
|------------|------|----|----|----|----|----|----|
| 1020 05 05 | M5   | 8  | 4  | 23 | 14 | 4  | 10 |
| 1020 10 10 | 1/8" | 10 | 7  | 38 | 19 | 7  | 10 |
| 1020 13 13 | 1/4" | 12 | 10 | 49 | 24 | 10 | 10 |
| 1020 17 17 | 3/8" | 16 | 11 | 54 | 26 | 11 | 10 |
| 1020 21 21 | 1/2" | 20 | 13 | 65 | 31 | 13 | 5  |
| 1020 27 27 | 3/4" | 27 | 15 | 69 | 32 | 15 | 5  |
| 1020 34 34 | 1"   | 30 | 17 | 84 | 39 | 17 | 2  |

**1021**

BSP conisch / BSP conique / BSPT / konischem Gewinde

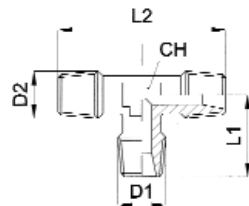

| Alfafit    | D1   | D2   | CH | L1 | L2 | #  |
|------------|------|------|----|----|----|----|
| 1021 05 05 | M5   | M5   | 8  | 14 | 28 | 10 |
| 1021 10 10 | 1/8" | 1/8" | 10 | 19 | 38 | 10 |
| 1021 13 13 | 1/4" | 1/4" | 12 | 24 | 48 | 10 |
| 1021 17 17 | 3/8" | 3/8" | 16 | 26 | 52 | 10 |
| 1021 21 21 | 1/2" | 1/2" | 20 | 31 | 62 | 5  |
| 1021 27 27 | 3/4" | 3/4" | 27 | 32 | 64 | 5  |
| 1021 34 34 | 1"   | 1"   | 30 | 39 | 78 | 2  |

**1122**

BSP cilindrisch / BSP cylindrique / BSPP / zylindrischem Gewinde

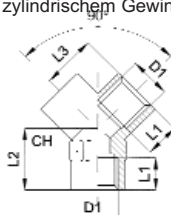

| Alfafit    | D1   | CH | L1 | L2 | L3 | #  |
|------------|------|----|----|----|----|----|
| 1122 10 10 | 1/8" | 14 |    |    |    | 10 |
| 1122 13 13 | 1/4" | 17 |    |    |    | 10 |
| 1122 17 17 | 3/8" | 22 |    |    |    | 10 |
| 1122 21 21 | 1/2" | 26 |    |    |    | 5  |

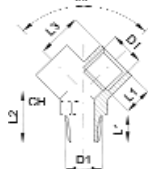
**1023**buitendr. BSP con., binnendr. BSP cil. / fil. mâle: BSP con., fil. fem.: BSP cyl.  
male thread: BSPT, female thread: BSPP / R-Außengew., G-Innengew.

| Alfafit    | D1   | L1 | CH | L2 | L3 | #  |
|------------|------|----|----|----|----|----|
| 1023 10 10 | 1/8" | 6  | 14 |    |    | 10 |
| 1023 13 13 | 1/4" | 8  | 17 |    |    | 10 |
| 1023 17 17 | 3/8" | 39 | 22 |    |    | 10 |
| 1023 21 21 | 1/2" | 10 | 26 |    |    | 5  |

1124

BSP cilindrisch / BSP cylindrique / BSPP / zylindrischem Gewinde

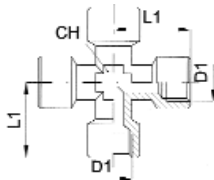

|            | D1   | CH | L1 | #  |
|------------|------|----|----|----|
| 1124 10 10 | 1/8" | 10 | 19 | 10 |
| 1124 13 13 | 1/4" | 12 | 25 | 10 |
| 1124 17 17 | 3/8" | 16 | 28 | 5  |
| 1124 21 21 | 1/2" | 20 | 34 | 5  |

1025

buitendr. BSP con., binnendr. BSP cil. / fil. mâle: BSP con., fil. fem.: BSP cyl. male thread: BSPT, female thread: BSPP / R-Außengew., G-Innengew.

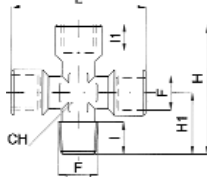

|            | F    | I  | CH | L  | H1 | H  | #  |
|------------|------|----|----|----|----|----|----|
| 1025 10 10 | 1/8" | 8  | 10 | 38 | 19 | 38 | 10 |
| 1025 13 13 | 1/4" | 10 | 12 | 50 | 24 | 49 | 10 |
| 1025 17 17 | 3/8" | 12 | 16 | 56 | 26 | 54 | 5  |
| 1025 21 21 | 1/2" | 15 | 20 | 68 | 31 | 65 | 5  |

1026

BSP conisch / BSP conique / BSPT / konischem Gewinde



|            | A    | B  | C  | a  | #  |
|------------|------|----|----|----|----|
| 1026 10 10 | 1/8" | 8  | 38 | 10 | 10 |
| 1026 13 13 | 1/4" | 10 | 48 | 13 | 10 |
| 1026 17 17 | 3/8" | 12 | 52 | 17 | 5  |
| 1026 21 21 | 1/2" | 15 | 62 | 21 | 5  |

1031

BSP conisch / BSP conique / BSPT / konischem Gewinde

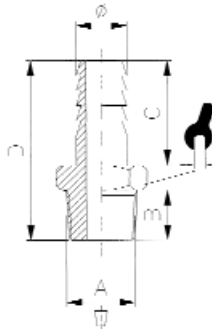

|            | Ø  | A    | B    | C    | D    | a  | #  |
|------------|----|------|------|------|------|----|----|
| 1031 10 06 | 6  | 1/8" | 7,5  | 19,5 | 32   | 12 | 50 |
| 1031 10 07 | 7  | 1/8" | 7,5  | 19,5 | 32   | 12 | 50 |
| 1031 10 08 | 8  | 1/8" | 7,5  | 19,5 | 32   | 12 | 50 |
| 1031 10 09 | 9  | 1/8" | 7,5  | 19,5 | 32   | 12 | 50 |
| 1031 10 10 | 10 | 1/8" | 7,5  | 19,5 | 32   | 12 | 50 |
| 1031 13 06 | 6  | 1/4" | 11   | 19,5 | 35,5 | 14 | 50 |
| 1031 13 07 | 7  | 1/4" | 11   | 19,5 | 35,5 | 14 | 50 |
| 1031 13 08 | 8  | 1/4" | 11   | 19,5 | 35,5 | 14 | 50 |
| 1031 13 09 | 9  | 1/4" | 11   | 19,5 | 35,5 | 14 | 50 |
| 1031 13 10 | 10 | 1/4" | 11   | 19,5 | 35,5 | 14 | 50 |
| 1031 13 12 | 12 | 1/4" | 11   | 19,5 | 35,5 | 14 | 50 |
| 1031 17 09 | 9  | 3/8" | 11,5 | 19,5 | 36   | 17 | 50 |
| 1031 17 10 | 10 | 3/8" | 11,5 | 19,5 | 36   | 17 | 50 |
| 1031 17 12 | 12 | 3/8" | 11,5 | 19,5 | 36   | 17 | 50 |
| 1031 17 14 | 14 | 3/8" | 11,5 | 19,5 | 36   | 17 | 10 |
| 1031 17 16 | 16 | 3/8" | 11,5 | 19,5 | 36   | 17 | 10 |
| 1031 21 09 | 9  | 1/2" | 14   | 19,5 | 39   | 22 | 10 |
| 1031 21 10 | 10 | 1/2" | 14   | 19,5 | 39   | 22 | 10 |
| 1031 21 12 | 12 | 1/2" | 14   | 19,5 | 39   | 22 | 10 |
| 1031 21 14 | 14 | 1/2" | 14   | 19,5 | 39   | 22 | 10 |
| 1031 21 16 | 16 | 1/2" | 14   | 19,5 | 39   | 22 | 10 |
| 1031 21 17 | 17 | 1/2" | 14   | 19,5 | 39   | 22 | 10 |
| 1031 21 18 | 18 | 1/2" | 14   | 19,5 | 39   | 22 | 10 |

1130

BSP cilindrisch / BSP cylindrique / BSPP / zylindrischem Gewinde

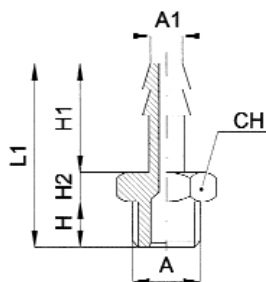

|            | A    | A1 | H  | H1 | H2  | L1   | CH | #  |
|------------|------|----|----|----|-----|------|----|----|
| 1130 05 06 | M5   | 6  |    |    |     |      |    | 50 |
| 1130 05 07 | M5   | 7  |    |    |     |      |    | 50 |
| 1130 10 06 | 1/8" | 6  | 6  | 18 | 4   | 28   | 12 | 50 |
| 1130 10 07 | 1/8" | 7  | 6  | 18 | 4   | 28   | 12 | 50 |
| 1130 10 08 | 1/8" | 8  | 6  | 18 | 4   | 28   | 12 | 50 |
| 1130 10 09 | 1/8" | 9  | 6  | 18 | 4   | 28   | 12 | 50 |
| 1130 10 12 | 1/8" | 12 | 6  | 18 | 4   | 28   | 12 | 50 |
| 1130 13 07 | 1/4" | 7  | 8  | 18 | 4,5 | 30,5 | 17 | 50 |
| 1130 13 08 | 1/4" | 8  | 8  | 18 | 4,5 | 30,5 | 17 | 50 |
| 1130 13 09 | 1/4" | 9  | 8  | 18 | 4,5 | 30,5 | 17 | 50 |
| 1130 13 12 | 1/4" | 12 | 8  | 18 | 4,5 | 30,5 | 17 | 50 |
| 1130 17 09 | 3/8" | 9  | 9  | 18 | 5   | 32   | 19 | 10 |
| 1130 17 12 | 3/8" | 12 | 9  | 18 | 5   | 32   | 19 | 10 |
| 1130 17 17 | 3/8" | 17 | 9  | 18 | 5   | 32   | 19 | 10 |
| 1130 21 12 | 1/2" | 12 | 10 | 18 | 6   | 34   | 24 | 10 |
| 1130 21 14 | 1/2" | 14 | 10 | 18 | 6   | 34   | 24 | 10 |
| 1130 21 17 | 1/2" | 17 | 10 | 18 | 6   | 34   | 24 | 10 |
| 1130 21 19 | 1/2" | 19 | 10 | 18 | 6   | 34   | 24 | 10 |

1004

BSP conisch / BSP conique / BSPT / konischem Gewinde

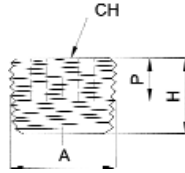

|            | A    | H  | P | CH | #   |
|------------|------|----|---|----|-----|
| 1004 10 00 | 1/8" | 8  | 4 | 5  | 100 |
| 1004 13 00 | 1/4" | 10 | 5 | 6  | 50  |
| 1004 17 00 | 3/8" | 10 | 6 | 8  | 50  |
| 1004 21 00 | 1/2" | 12 | 8 | 10 | 50  |

1110

BSP cilindrisch / BSP cylindrique / BSPP / zylindrischem Gewinde

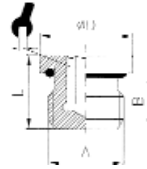

|            | A    | B  | L  | a  | ØD | #  |
|------------|------|----|----|----|----|----|
| 1110 10 00 | 1/8" | 6  | 9  | 6  | 13 | 50 |
| 1110 13 00 | 1/4" | 8  | 11 | 8  | 16 | 50 |
| 1110 17 00 | 3/8" | 10 | 14 | 10 | 20 | 10 |
| 1110 21 00 | 1/2" | 11 | 15 | 12 | 25 | 10 |

1112

BSP cilindrisch / BSP cylindrique / BSPP / zylindrischem Gewinde

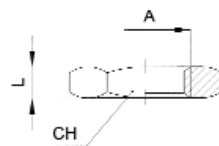
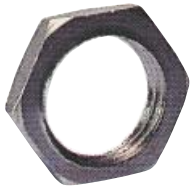

|            | A    | L   | CH | #  |
|------------|------|-----|----|----|
| 1112 05 00 | M5   | 2,5 | 8  | 50 |
| 1112 10 00 | 1/8" | 3   | 12 | 50 |
| 1112 13 00 | 1/4" | 3   | 16 | 50 |
| 1112 17 00 | 3/8" | 3,5 | 19 | 10 |
| 1112 21 00 | 1/2" | 4   | 24 | 10 |
| 1112 27 00 | 3/4" | 4,5 | 30 | 10 |
| 1112 34 00 | 1"   | 5   | 38 | 10 |

1150

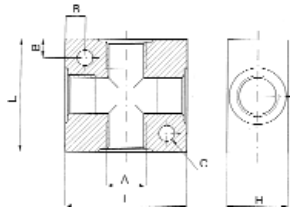
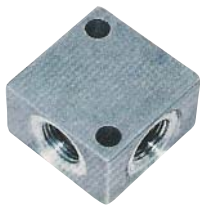

|            | A    | B | L  | ØC  | H  | N* | #  |
|------------|------|---|----|-----|----|----|----|
| 1150 10 04 | 1/8" | 4 | 25 | 4,5 | 15 | 4  | 10 |
| 1150 13 04 | 1/4" | 7 | 40 | 5,5 | 20 | 4  | 10 |
| 1150 17 04 | 3/8" | 8 | 50 | 5,5 | 25 | 4  | 5  |
| 1150 21 04 | 1/2" | 8 | 50 | 5,5 | 33 | 4  | 5  |

N\*: aantal aansl. / nb de trous / no. of ports / Anz. Bohrung

1152

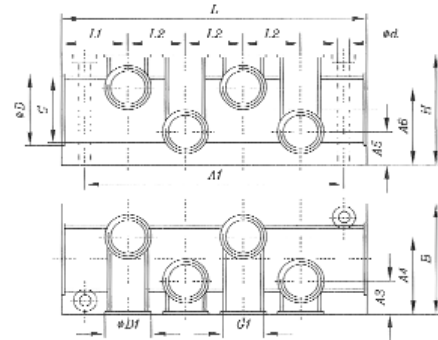

|               | G    | ØD   | G1   | ØD1  | B  | H  | L   | L1   | L2 | A1  | A3   | A4   | A5   | A6   | Ød  | N*  | # |
|---------------|------|------|------|------|----|----|-----|------|----|-----|------|------|------|------|-----|-----|---|
| 1152 13 05 08 | 1/4" | 19   | M5   | 8,5  | 32 | 25 | 65  | 17,5 | 10 | 50  | 12,5 | 19,5 | 8,5  | 16,5 | 4,4 | 2+8 | 1 |
| 1152 17 10 08 | 3/8" | 23   | 1/8" | 14,5 | 40 | 30 | 114 | 22,5 | 23 | 100 | 16,5 | 24,5 | 10,5 | 19,5 | 6,5 | 2+8 | 1 |
| 1152 21 13 08 | 1/2" | 27,5 | 1/4" | 19   | 50 | 35 | 144 | 28,5 | 29 | 128 | 20,5 | 29,5 | 13   | 22   | 6,5 | 2+8 | 1 |
| 1152 27 21 08 | 3/4" | 34   | 1/2" | 27,5 | 60 | 45 | 170 | 31   | 36 | 150 | 27   | 33   | 19,5 | 25,5 | 8,5 | 2+8 | 1 |

N\*: aantal aansluitingen/ nombre de trous / no. of ports / Anz. Bohrung

1153

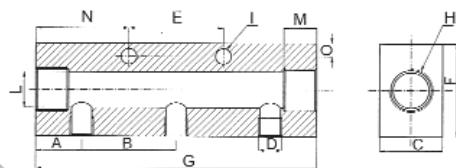
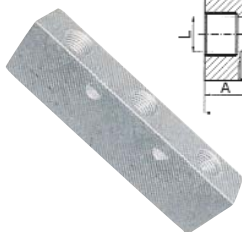

|               | L    | D    | C  | F  | N  | B  | A  | G   | N*  | # |
|---------------|------|------|----|----|----|----|----|-----|-----|---|
| 1153 13 10 02 | 1/4" | 1/8" | 20 | 30 | 30 | 30 | 15 | 60  | 2+2 | 2 |
| 1153 13 10 03 | 1/4" | 1/8" | 20 | 30 | 30 | 30 | 15 | 90  | 2+3 | 2 |
| 1153 13 10 04 | 1/4" | 1/8" | 20 | 30 | 30 | 30 | 15 | 120 | 2+4 | 2 |
| 1153 13 10 05 | 1/4" | 1/8" | 20 | 30 | 30 | 30 | 15 | 150 | 2+5 | 2 |
| 1153 17 13 02 | 3/8" | 1/4" | 20 | 30 | 36 | 36 | 18 | 72  | 2+2 | 2 |
| 1153 17 13 03 | 3/8" | 1/4" | 20 | 30 | 36 | 36 | 18 | 108 | 2+3 | 2 |
| 1153 17 13 04 | 3/8" | 1/4" | 20 | 30 | 36 | 36 | 18 | 144 | 2+4 | 2 |
| 1153 17 13 05 | 3/8" | 1/4" | 20 | 30 | 36 | 36 | 18 | 180 | 2+5 | 2 |

N\*: aantal aansl. / nb de trous / no. of ports / Anz. Bohrung

**1154**

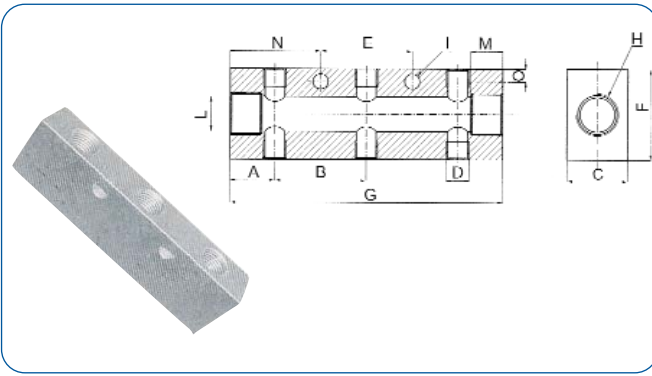

|               | L/H  | D    | C  | F  | N  | B  | A  | G   | N*   | # |
|---------------|------|------|----|----|----|----|----|-----|------|---|
| 1154 13 10 04 | 1/4" | 1/8" | 20 | 30 | 30 | 30 | 15 | 60  | 2+4  | 2 |
| 1154 13 10 06 | 1/4" | 1/8" | 20 | 30 | 30 | 30 | 15 | 90  | 2+6  | 2 |
| 1154 13 10 08 | 1/4" | 1/8" | 20 | 30 | 30 | 30 | 15 | 120 | 2+8  | 2 |
| 1154 13 10 10 | 1/4" | 1/8" | 20 | 30 | 30 | 30 | 15 | 150 | 2+10 | 2 |
| 1154 17 13 04 | 3/8" | 1/4" | 20 | 40 | 36 | 36 | 18 | 72  | 2+4  | 2 |
| 1154 17 13 06 | 3/8" | 1/4" | 20 | 30 | 36 | 36 | 18 | 108 | 2+6  | 2 |
| 1154 17 13 08 | 3/8" | 1/4" | 20 | 30 | 36 | 36 | 18 | 144 | 2+8  | 2 |
| 1154 17 13 10 | 3/8" | 1/4" | 20 | 30 | 36 | 36 | 18 | 180 | 2+10 | 2 |
| 1154 21 13 06 | 1/2" | 1/4" | 28 | 40 | 40 | 36 | 22 | 116 | 2+6  | 2 |
| 1154 21 13 08 | 1/2" | 1/4" | 28 | 40 | 40 | 36 | 22 | 152 | 2+8  | 2 |

N\*: aantal aansl. / nb de trous / no. of ports / Anz. Bohrung

**1155**

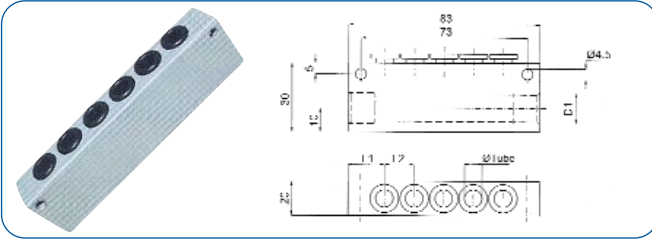

|               | Ø | D1   | L1   | L2 | N*  | # |
|---------------|---|------|------|----|-----|---|
| 1155 04 13 06 | 4 | 1/4" | 14   | 11 | 2+6 | 1 |
| 1155 06 13 05 | 6 | 1/4" | 15,5 | 13 | 2+5 | 1 |
| 1155 08 17 04 | 8 | 3/8" | 17,5 | 16 | 2+4 | 1 |

N\*: aantal aansl. / nb de trous / no. of ports / Anz. Bohrung

**InduParts Pneumatics B.V.B.A.**  
 Sint-Jorisstraat 40  
 B-8800 ROESELARE  
 BELGIË  
 BE 0471.741.880

tel. +32 (0)51 22 58 88  
 fax. +32 (0)51 22 58 98  
 info@induparts.com  
 www.induparts.com